

# PROFILING

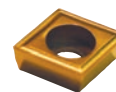

## BORING SMALL DIAMETER

CPGM

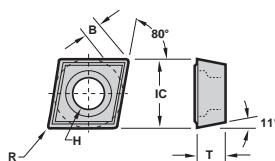

Description	EDP Code	IC	R	T	B	H	TIN Coated		AITIN Coated	
							GP25	GP50	AC25	AC50
CPGM-21.50	SA20	1/4	0.10	2.39	1.71	2.79	●	●	●	●
CPGM-21.505	SA205	1/4	0.20	2.39	1.65	2.79	●	●	●	●
CPGM-21.51	SA21	1/4	0.38	2.39	1.54	2.79	●	●	●	●
CPGM-21.52	SA22	1/4	0.79	2.39	1.32	2.79	●	●	●	●
CPGM-32.50	SA30	3/8	0.10	3.96	2.59	4.39	●	●	●	●
CPGM-32.505	SA305	3/8	0.20	3.96	2.53	4.39	●	●	●	●
CPGM-32.51	SA31	3/8	0.38	3.96	2.17	4.39	●	●	●	●
CPGM-32.52	SA32	3/8	0.79	3.96	2.20	4.39	●	●	●	●

## 55° DIAMOND PROFILING

DPGR

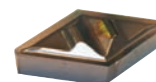
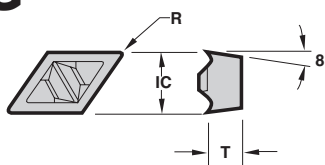

Description	EDP Code	D	T	R	TIN Coated		AITIN Coated	
					GP25	GP50	AC25	AC50
DPGR-432	643432	12.70	4.75	0.79	●	●	●	●

## 55° PARALLELOGRAM PROFILING

FLPGL/R

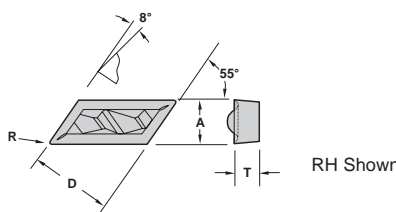

Description	EDP Code	D	T	A	R	TIN Coated		AITIN Coated	
						GP25	GP50	AC25	AC50
FLPGL-51	641G51	9.53	3.18	6.35	0.38	●	●	●	●
FLPGR-51	642G51	9.53	3.18	6.35	0.38	●	●	●	●
FLPGL-52	641G52	9.53	3.18	6.35	0.79	●	●	●	●
FLPGR-52	642G52	9.53	3.18	6.35	0.79	●	●	●	●

PROFILING

FLPL/R

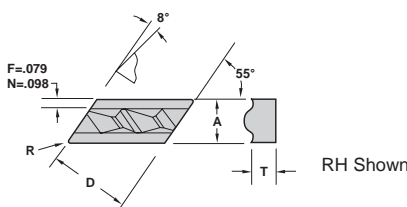
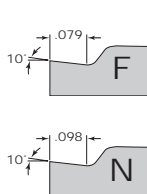

Description	EDP Code	R	T	D	A	TIN Coated		AITIN Coated	
						GP25	GP50	AC25	AC50
FLPR-50.5	642505	0.13	3.18	9.53	6.35	●	●	●	●
FLPL-50.5	641505	0.13	3.18	9.53	6.35	●	●	●	●
FLPR-51	64251	0.38	3.18	9.53	6.35	●	●	●	●
FLPL-51	64151	0.38	3.18	9.53	6.35	●	●	●	●
FLPR-52	64252	0.79	3.18	9.53	6.35	●	●	●	●
FLPL-52	64152	0.79	3.18	9.53	6.35	●	●	●	●
FLPR-130.5	6421305	0.13	4.75	12.70	9.53	●	●	●	●
FLPL-130.5	6411305	0.13	4.75	12.70	9.53	●	●	●	●
FLPR-131F	642131F	0.38	4.75	12.70	9.53	●	●	●	●
FLPL-131F	641131F	0.38	4.75	12.70	9.53	●	●	●	●
FLPR-132F	642132F	0.79	4.75	12.70	9.53	●	●	●	●
FLPL-132F	641132F	0.79	4.75	12.70	9.53	●	●	●	●
FLPR-132N	642132N	0.79	4.75	12.70	9.53	●	●	●	●
FLPL-132N	641132N	0.79	4.75	12.70	9.53	●	●	●	●
FLPR-331N	642331N	0.38	4.75	18.64	9.53	●	●	●	●
FLPL-331N	641331N	0.38	4.75	18.64	9.53	●	●	●	●
FLPR-332F	642332F	0.79	4.75	18.64	9.53	●	●	●	●
FLPL-332F	641332F	0.79	4.75	18.64	9.53	●	●	●	●
FLPR-332N	642332N	0.79	4.75	18.64	9.53	●	●	●	●
FLPL-332N	641332N	0.79	4.75	18.64	9.53	●	●	●	●

In an effort to improve our stock standard grade offering, there are periodic changes. Please see current price list for up to date grade offering.

● High performance choice in optimal conditions.  
▲ Recommended grade under general conditions.

Cast Iron	▲	●		
Non-Ferrous	▲	●		
Stainless/High Temp	▲	●		
Steel	▲	●		



# PROFILING

## 35° DIAMOND PROFILING

VPGR

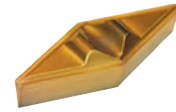
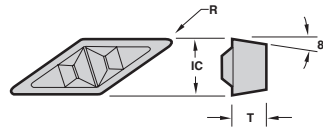

Description	EDP Code	IC	T	R	TIN Coated		ATTN Coated	
					GP25	GP50	AC25	AC50
VPGR-330.5	6443305	3/8	4.75	0.20	●	●	●	●
VPGR-331	644331	3/8	4.75	0.38	●	●	●	●
VPGR-332	644332	3/8	4.75	0.79	●	●	●	●

In an effort to improve our stock standard grade offering, there are periodic changes. Please see current price list for up to date grade offering.

● High performance choice in optimal conditions.  
▲ Recommended grade under general conditions.

Cast Iron	▲	●	
Non-Ferrous			
Stainless/High Temp	▲	●	
Steel		▲	●

## EXTERNAL HOLDERS

FLDLPR/L  
Profiling

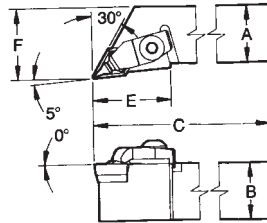

RH SHOWN

### PARTS

Description	EDP Code	Insert	A	B	C	E	F	Seat	Seat			Clamp
									Screw	Clamp	Screw	
FLDLPR-2525M4D		928325M25	DPGR-432	25.00	25.00	150.00	35.05	31.75	SM-414	S-111	CM116	SBM-532
FLDLPL-2525M4D		928225M25	DPGR-432	25.00	25.00	150.00	35.05	31.75	SM-414	S-111	CM117	SBM-532
FLDLPR-3232M4D		928332M25	DPGR-432	32.00	32.00	150.00	35.05	38.10	SM-414	S-111	CM116	SBM-532
FLDLPL-3232M4D		928232M25	DPGR-432	32.00	32.00	150.00	35.05	38.10	SM-414	S-111	CM117	SBM-532

FLVLCR/L  
Profiling

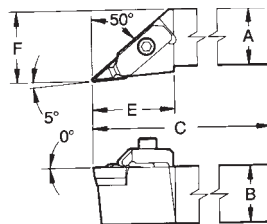

RH SHOWN

### PARTS

Description	EDP Code	Insert	A	B	C	E	F	Seat	Seat			Clamp
									Screw	Clamp	Screw	
FLVLCR-2020M3B		935320M26	VPGR-33	20.00	20.00	125.00	36.58	25.40	SM-412	S-959	CM113	SSM51
FLVLCL-2020M3B		935220M26	VPGR-33	20.00	20.00	125.00	36.58	25.40	SM-412	S-959	CM114	SSM51
FLVLCR-2525M3D		935325M26	VPGR-33	25.00	25.00	150.00	36.58	31.75	SM-412	S-959	CM113	SSM51
FLVLCL-2525M3D		935225M26	VPGR-33	25.00	25.00	150.00	36.58	31.75	SM-412	S-959	CM114	SSM51
FLVLCR-3232M3D		935332M26	VPGR-33	32.00	32.00	150.00	36.58	38.10	SM-412	S-959	CM113	SSM51
FLVLCL-3232M3D		935232M26	VPGR-33	32.00	32.00	150.00	36.58	38.10	SM-412	S-959	CM114	SSM51

PROFILING



## EXTERNAL HOLDERS

### FLVVCN Profiling

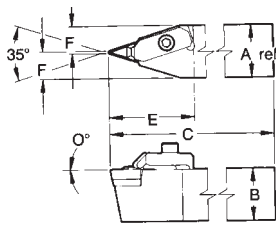

#### PARTS

Description	EDP Code	Insert	A	B	C	E	F	Seat	Seat Clamp			Clamp
									Screw	Screw	Screw	
FLVVCN-25M3D		935425M26	VPGR-33_	25	25	150	41.15	13.26	SM-412	S-959	CM113	SSM51
FLVVCN-32M3D		935432M26	VPGR-33_	32	32	170	41.15	16.43	SM-412	S-959	CM113	SSM51

### FLDPPN Profiling

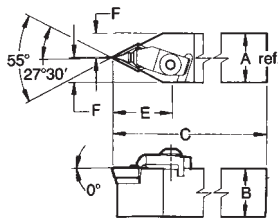

#### PARTS

Description	EDP Code	Insert	A	B	C	E	F	Seat	Seat Clamp			Clamp
									Screw	Screw	Screw	
FLDPPN-25M4D		928425M25	DPGR-432	25	25	150	40.39	13.18	SM-414	S-111	CM116	SBM-532
FLDPPN-32M4D		928432M25	DPGR-432	32	32	170	40.39	16.36	SM-414	S-111	CM116	SBM-532

### FLKL Profiling

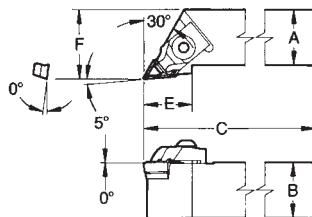

#### PARTS

Description	EDP Code	Insert	A	B	C	F	E	Seat	Seat Clamp			Clamp
									Screw	Screw	Screw	
FLKLCR-12M05V		931312M29	FLPR-5_*	12	12	80	19.05	22.23	SM-285	S-959	CM79	SBM-524
FLKLCL-12M05V		931212M29	FLPL-5_*	12	12	80	19.05	22.23	SM-286	S-959	CM71	SBM-524
FLKLCR-20M05B		931320M29	FLPR-5_*	20	20	125	25.40	22.23	SM-285	S-959	CM68	SBM-524
FLKLCL-20M05B		931220M29	FLPL-5_*	20	20	125	25.40	22.23	SM-286	S-959	CM68	SBM-524
FLKLNLR-20M1B		931320M30	FLPR-13_	20	20	125	25.40	31.75	SM-272	SL-344	CM66	SBM-625
FLKLNL-20M1B		931220M30	FLPL-13_	20	20	125	25.40	31.75	SM-271	SL-344	CM66	SBM-625
FLKLNLR-25M1C		931325M30	FLPR-13_	25	25	150	19.05	22.23	SM-272	SL-344	CM66	SBM-625
FLKLNL-25M1C		931225M30	FLPL-13_	25	25	150	19.05	22.23	SM-271	SL-344	CM66	SBM-625
FLKLNLR-25M3D		931325M31	FLPR-33_	25	25	150	38.10	22.23	SM-268	SL-344	CM65	SBM-625
FLKLNL-25M3D		931225M31	FLPL-33_	25	25	150	38.10	22.23	SM-267	SL-344	CM65	SBM-625
FLKLNLR-32M3D		931332M31	FLPR-33_	32	32	170	38.10	36.53	SM-268	SL-344	CM65	SBM-625
FLKLNL-32M3D		931232M31	FLPL-33_	32	32	170	38.10	36.53	SM-267	SL-344	CM65	SBM-625

\*Also used with inserts FLPR/FLPL.



# PROFILING

## EXTERNAL HOLDERS

FLKL-F  
Profiling

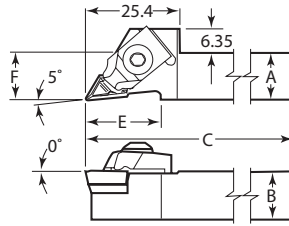

### PARTS

Description	EDP Code	Insert	A	B	C	E	F	Seat	Seat Clamp			
									Screw	Clamp	Screw	
FLKLCRF-12M05D		931512M29	FLPR-5_*	12	12	150	19.05	12.70	SM-285	S-959	CM180	SBM-524
FLKLCLF-12M05D		931412M29	FLPL-5_*	12	12	150	19.05	12.70	SM-286	S-959	CM181	SBM-524
FLKLCRF-16M05B		931516M29	FLPR-5_*	16	16	100	19.05	15.88	SM-285	S-959	CM180	SBM-524
FLKLCLF-16M05B		931416M29	FLPL-5_*	16	16	100	19.05	15.88	SM-286	S-959	CM181	SBM-524

\*Also used with inserts FLPGR/FLPGL.

FLKPCN  
Profiling

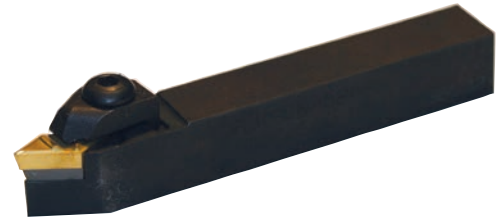
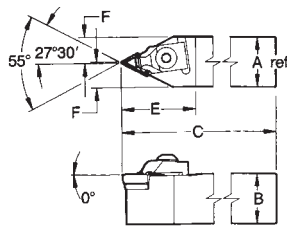

### PARTS

Description	EDP Code	Insert	A	B	C	E	F	Seat	Seat Clamp			
									Screw	Clamp	Screw	
FLKPCN-12M05V		931612M29V	FLPR-5_*	12	12	80	28.58	6.60	SM-285	S-959	CM79	SBM-524
FLKPCN-12M05D		931612M29D	FLPR-5_*	12	12	150	28.58	6.60	SM-285	S-959	CM79	SBM-524
FLKPCN-20M05B		931620M29	FLPR-5_*	20	20	125	28.58	9.78	SM-285	S-959	CM68	SBM-524

\*Also used with inserts FLPGR/FLPGL.

## INTERNAL BARS

A-FLDL  
Profiling

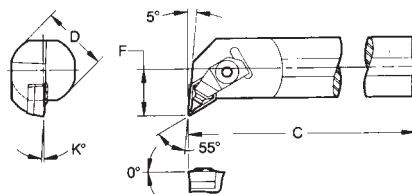

### PARTS

Description	EDP Code	Insert	D	C	F	K°	Bore	Min. Seat	Seat Clamp			
									Screw	Clamp	Screw	
A32M-FLDLPR4		905232M25	DPGR-432	32	350	22.23	3°	40.26	SM-414	S-111	CM118	SBM-532
A32M-FLDLPL4		905032M25	DPGR-432	32	350	22.23	3°	40.26	SM-414	S-111	CM119	SBM-532
A40M-FLDLPR4		905240M25	DPGR-432	40	350	25.40	2°	46.61	SM-414	S-111	CM118	SBM-532
A40M-FLDLPL4		905040M25	DPGR-432	40	350	25.40	2°	46.61	SM-414	S-111	CM119	SBM-532
A44M-FLDLPR4		905244M25	DPGR-432	44	350	28.58	2°	53.85	SM-414	S-111	CM118	SBM-532
A44M-FLDLPL4		905044M25	DPGR-432	44	350	28.58	2°	53.85	SM-414	S-111	CM119	SBM-532
A50M-FLDLPR4		905250M25	DPGR-432	50	400	31.75	2°	60.96	SM-414	S-111	CM118	SBM-532
A50M-FLDLPL4		905050M25	DPGR-432	50	400	31.75	2°	60.96	SM-414	S-111	CM119	SBM-532

PROFILING





## INTERNAL BARS

### A-FLKL Profiling

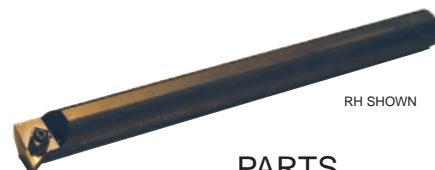
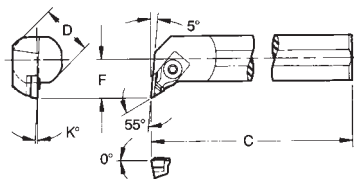

#### PARTS

Description	EDP Code	Insert	D	C	F	K°	Bore	Min. Seat	Clamp			
									Screw	Seat Clamp	Screw	Clamp
A16M-FLKLCR05		905616M29	FLPL-5_*	16	250	12.70	5°	22.86	SM-286	S-959	CM79	SBM-524
A16M-FLKLCL05		905416M29	FLPR-5_*	16	250	12.70	5°	22.86	SM-285	S-959	CM71	SBM-524
A20M-FLKLCR05		905620M29	FLPL-5_*	20	250	14.27	5°	24.89	SM-286	S-959	CM79	SBM-524
A20M-FLKLCL05		905420M29	FLPR-5_*	20	250	14.27	5°	24.89	SM-285	S-959	CM71	SBM-524
A25M-FLKLCR05		905625M29	FLPL-5_*	25	300	19.05	3°	33.02	SM-286	S-959	CM68	SBM-524
A25M-FLKLCL05		905425M29	FLPR-5_*	25	300	19.05	3°	33.02	SM-285	S-959	CM68	SBM-524
A32M-FLKLCR05		905632M29	FLPL-5_*	32	350	22.23	3°	40.26	SM-286	S-959	CM68	SBM-524
A32M-FLKLCL05		905432M29	FLPR-5_*	32	350	22.23	3°	40.26	SM-285	S-959	CM68	SBM-524
A40M-FLKLCR05		905640M29	FLPL-5_*	40	350	25.40	2°	46.61	SM-286	S-959	CM68	SBM-524
A40M-FLKLCL05		905440M29	FLPR-5_*	40	350	25.40	2°	46.61	SM-285	S-959	CM68	SBM-524
A50M-FLKLCR05		905650M29	FLPL-5_*	50	400	31.75	2°	60.96	SM-286	S-959	CM68	SBM-524
A50M-FLKLCL05		905450M29	FLPR-5_*	50	400	31.75	2°	60.96	SM-285	S-959	CM68	SBM-524

\*Also used with inserts FLPR/FLPGL.

### A-FLKQ Profiling

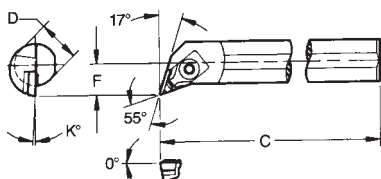

#### PARTS

Description	EDP Code	Insert	D	C	F	K°	Bore	Min. Seat	Clamp			
									Screw	Seat Clamp	Screw	Clamp
A12M-FLKQCR05		906012M29	FLPL-5_*	12	200	9.53	6°	17.02	-	-	CM112	SBM-518
A12M-FLKQCL05		905812M29	FLPR-5_*	12	200	9.53	6°	17.02	-	-	CM111	SBM-518
A20M-FLKQCR05		906020M29	FLPL-5_*	20	250	14.27	6°	24.89	SM-286	S-959	CM68	SBM-524
A20M-FLKQCL05		905820M29	FLPR-5_*	20	250	14.27	6°	24.89	SM-285	S-959	CM68	SBM-524
A25M-FLKQCR05		906025M29	FLPL-5_*	25	300	19.05	3°	33.02	SM-286	S-959	CM68	SBM-524
A25M-FLKQCL05		905825M29	FLPR-5_*	25	300	19.05	3°	33.02	SM-285	S-959	CM68	SBM-524

\*Also used with inserts FLPR/FLPGL.

### A-FLKX Profiling

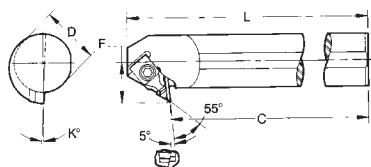

#### PARTS

Description	EDP Code	Insert	D	C	L	F	K°	Bore	Min. Seat	Clamp			
										Screw	Seat Clamp	Screw	Clamp
A20M-FLKXCR05		906420M29	FLPR-5_*	20	250	271.78	15.88	5°	26.92	SM-285	S-959	CM79	SBM-524
A20M-FLKXCL05		906220M29	FLPL-5_*	20	250	271.78	15.88	5°	26.92	SM-286	S-959	CM71	SBM-524
A25M-FLKXCR05		906425M29	FLPR-5_*	25	300	322.58	19.05	5°	33.02	SM-285	S-959	CM79	SBM-524
A25M-FLKXCL05		906225M29	FLPL-5_*	25	300	322.58	19.05	5°	33.02	SM-286	S-959	CM71	SBM-524

\*Also used with inserts FLPR/FLPGL.

### A-FLVL Profiling

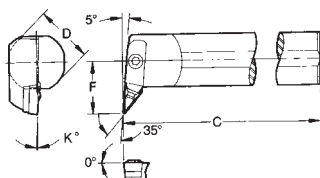

#### PARTS

Description	EDP Code	Insert	D	C	F	K°	Bore	Min. Seat	Clamp			
									Screw	Seat Clamp	Screw	Clamp
A20-FLVLCR3		90682026	VPGR-33_	32	350	28.58	2°	46.48	SM-412	S-959	CM113	SBM-412
A20-FLVLCL3		90662026	VPGR-33_	32	350	28.58	2°	46.48	SM-412	S-959	CM114	SBM-412
A24-FLVLCR3		90682426	VPGR-33_	40	350	31.75	2°	53.85	SM-412	S-959	CM113	SBM-412
A24-FLVLCL3		90662426	VPGR-33_	40	350	31.75	2°	53.85	SM-412	S-959	CM114	SBM-412
A32-FLVLCR3		90683226	VPGR-33_	50	400	38.10	2°	66.55	SM-412	S-959	CM113	SBM-412
A32-FLVLCL3		90663226	VPGR-33_	50	400	38.10	2°	66.55	SM-412	S-959	CM114	SBM-412